



QUICKMAP 3D[®] INCIDENT MAPPING APP

Collect Data Your Way
Field to Courtroom Synergy

Simplified Workflow
Mapping Packages

TRAFFIC SAFETY



Collect Data Your way

QM3D is adaptable to any scene with specialized mapping techniques for any situation or equipment assembly, available on Android™ and iOS devices. *Enjoy a 30-day free trial.*

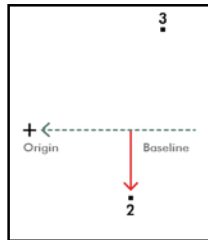

Baseline Offset

Occupy the roadside and measure all features at a 90° angle

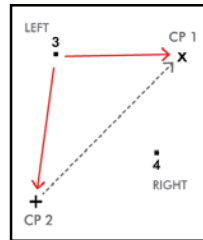

Range Triangulation

Occupy the feature and measure to the same two remote targets

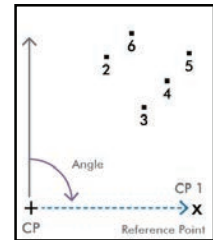

Radial with Angle

Occupy any safe location and measure to features at any angle

Improved Workflow

Take advantage of all the benefits from smart device technology and embrace an easier way to map.

- Transfer your field data wirelessly and say goodbye to cables
- Automatically receive feature updates via Google Play and App Store
- Solve problems right in the field with built-in help and support
- One-time License Purchase per Device

Map Points, Lines, Splines, and Areas

Make your survey visual by using line, curve and area features to see your map take shape as you go.

- Map and notate any individual point or group of points using a laser or GPS only, and change point of colors
- Transform a mapped feature type to any other feature type in two steps
- Draw an outline around irregular shapes using the area feature
- Easily catch and correct the most common mapping mistakes

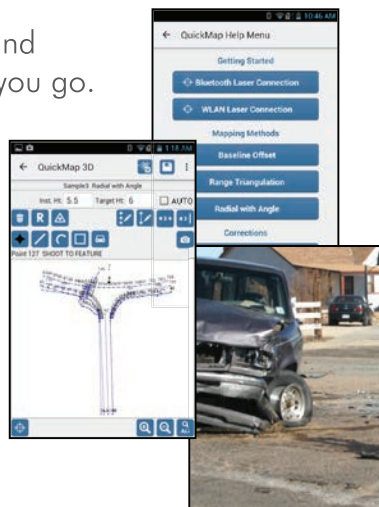

Organized Photo Data

Unlike any other mapping program, you can take photos of the scene that match up with your data set.

- Have photos automatically named by file name, point number, and note
- Use for your crash analysis reports
- Take additional up close photos of the same measurement point
- Insert images into CAD to enhance your 3D diagrams



REMOTE FIRE

Improve stability and targeting by using the remote fire capability from your tablet



REVIEW & EDIT

Review and edit points in the field and make quick corrections



SPLINE CURVE

Enjoy pre-diagramming that follows your lead with the advanced spline curve feature

Field to Courtroom Synergy

LTI offers two CAD-based diagramming programs as part of its complete mapping packages: FARO Zone 2D and FARO Zone 3D.

Compatible CAD Programs

- FARO Zone 2D & 3D
- CSI Office
- Aras 360
- Map360
- EdgeFX

QM3D Report Formats

- Text Report (*.txt)
- ASCII Report (*.asc.)
- Spreadsheet Report (*.csv)
- CAD File (*.dxf)
- Raw Data (*.raw)
- Graphic Small (*.png)
- Graphic Large (*.png)

Intuitive Help and Support

Your questions will be answered and problems solved right in the field with QM3D built-in help.

- Know exactly how to properly traverse from one control point to another step-by-step
- Email a diagnostic file direct to our support team in the event of a crash or survey anomaly
- Better understand how to set up and execute all three mapping methods
- Save time by utilizing the on-board conversion table



MAPPING PACKAGES

TruSpeed Sxb

Assembly is designed for Baseline Offset and Range Triangulation mapping methods

**Configuration also compatible with TruPulse 200X*



TruPulse 200X

Perfect for the Radial with Angle mapping method

**Configuration also compatible with TruSpeed Sxb*



TruPoint 300

Ideal for indoor or close proximity Radial with Angle mapping and crush analysis data collection



Search "LaserSoft QuickMap"



Check app stores for operating system compatibility.



REPOSITIONING

Easily pick up and move control points using a simple, step-by-step traverse routine



SPATIAL AWARENESS

Display background maps and change GPS point colors.



SAVE AND SEND

Eliminate cables to transfer your data and simply email it all



PROUDUCT SPECIFICATIONS

QUICKMAP 3D SPECIFICATIONS

	Android™ Devices	Apple Devices
Operating Systems <small>*Inquire at www.lasertech.com for latest operating system compatibility requirements</small>	Android version 6 - 10	iOS version 10 or later
Supported Devices	Most Android tablets running 6.0 or later	iPhone & iPad
Connectivity	Bluetooth and/or WLAN	Bluetooth
Compatible Lasers	TruSpeed Sxb, TruPulse 200X, TruPoint 300	
Supported Languages	English, Italian, French	English

*LaserSoft QuickMap licensing is a on-time purchase per device. Not a subscription product.

LASER SPECIFICATIONS



TruPulse® 200X



TruSpeed® Sxb



TruPoint™ 300

Range	Reflective 8,200 ft (2,500 m) Nonreflective 6,233 ft (1,900 m)	2,000 ft (609 m)	1,000 ft (300 m)
Speed	N/A	0 to 200 mph, ±1 mph accuracy	N/A
Range Accuracy	±1.6 in (4 cm) Typical		± 0.04 in (1 mm) Typical
Inclination Accuracy	±0.1° Typical		±0.1° Typical
Power	(1) CR123A Battery		Li-ion rechargeable

ANGLE ENCODERS



MapStar® TruAngle®



TruPoint™ 300

Angle Range	0 to 359.99°	
Angle Accuracy (Mounted)	±0.05°	±0.1°
Power	(2) AA Batteries, up to 8 hours use	Li-ion rechargeable
Communication	RS 232, NMEA	Bluetooth® SMART and WiFi